

SPECIFICATIONS

(Typical values for batteries stored at 20°C for one year)

Nominal Capacity (At 1mA/20°C/68°F/2.0V Cut-Off)	1.65 Ah
Open Circuit Voltage (At 20°C/68°F)	3.67 V
Nominal Voltage (At 1mA/20°C/68°F)	3.59 V
Maximum Continuous Current	60 mA
Maximum Pulse Current Capability	150 mA
Rated 1 Sec. Pulse Capability (To 3V)	30 mA
Operating Temperature Range	-55 ~ 85 °C
Weight	11.3 g (0.398oz)
Anode Surface Area	9.7 cm ²
Volume	5.5 cm ³
Diameter (Max)	14.5 mm
Height (Max)	33.5 mm

DIMENSIONS IN MM

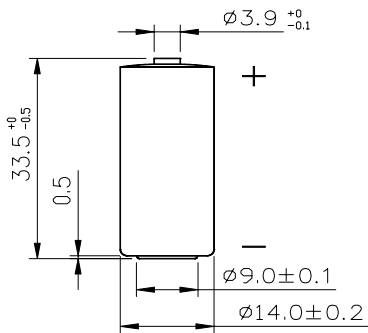

WARNING
Fire, Explosion And Severe Burn Hazard.
Do Not Recharge, Crush, Disassemble,
Heat Above 212°F(100°C), Incinerate
Or Expose Contents To Water

Voltage (V) DISCHARGE CHARACTERISTICS AT +20°C

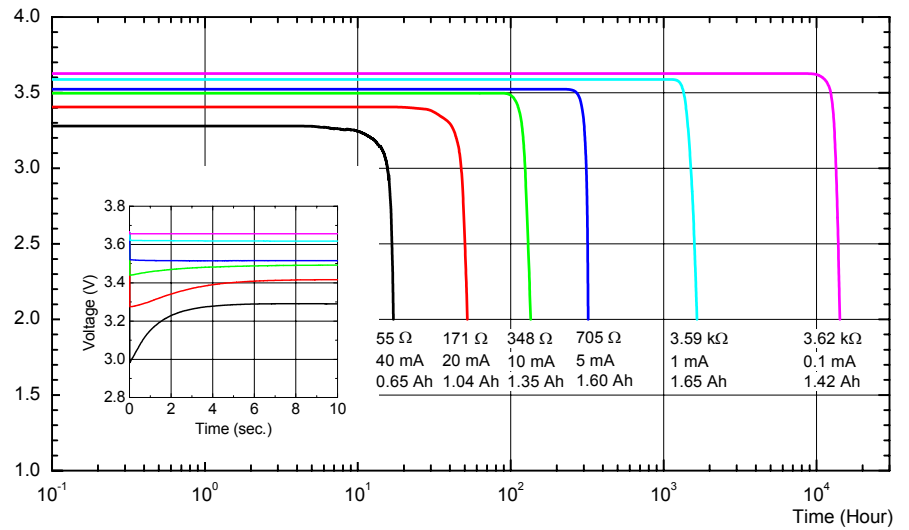

Capacity (Ah) CAPACITY vs. CURRENT

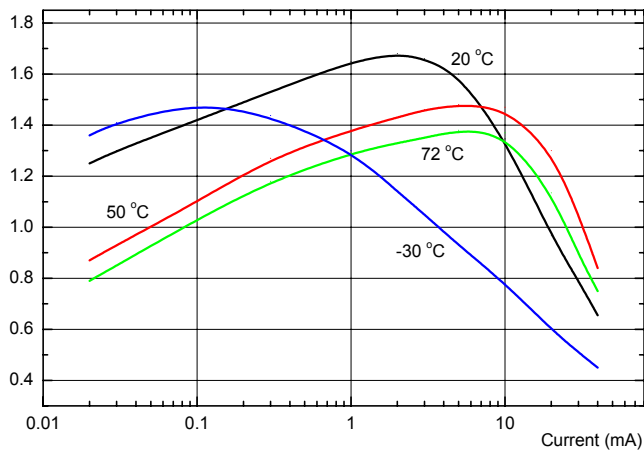

Voltage (V) OPERATING VOLTAGE

